

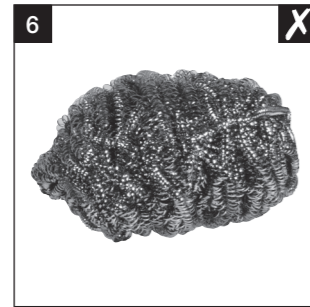

- ✓ OK
- ✗ not OK

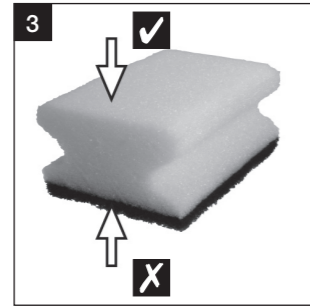

Art.-No.: 513 605

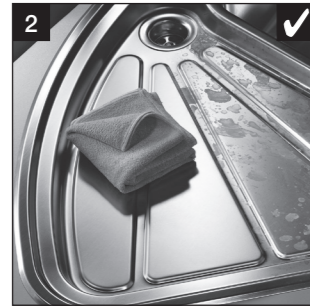
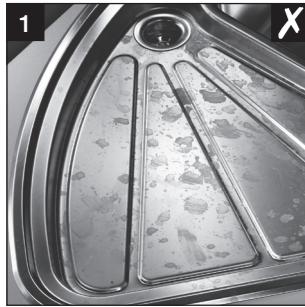
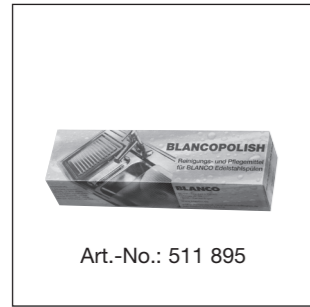

Art.-No.: 511 895



- ✓ OK
- ✗ not OK

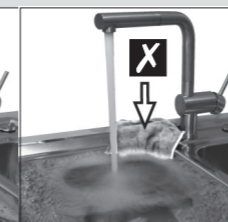
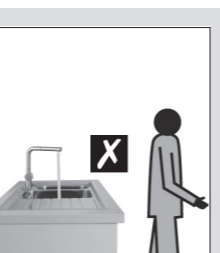
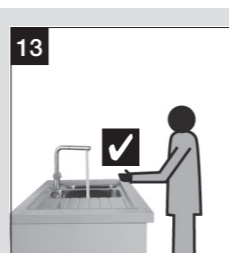
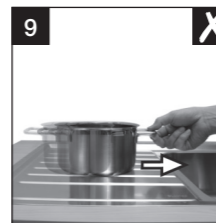
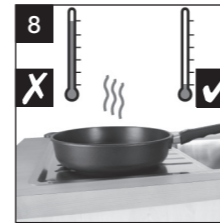
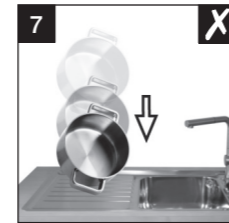
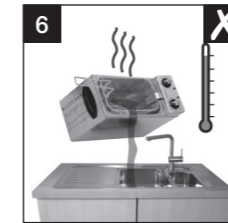
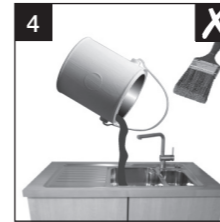
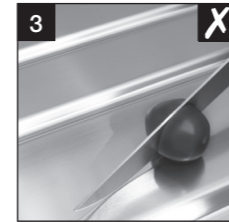
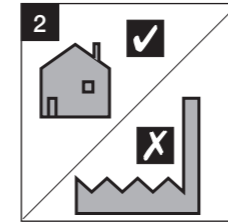
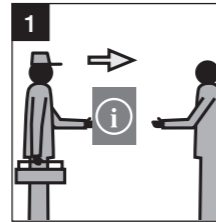

BLANCO

STEELART

BLANCO GmbH + Co KG
Technischer Kundendienst
Tel.: +49 7045 44-81 419
info@blanco.de
www.blanco.de
www.blanco-steelart.de

229 794 12/2012

BLANCO

STEELART



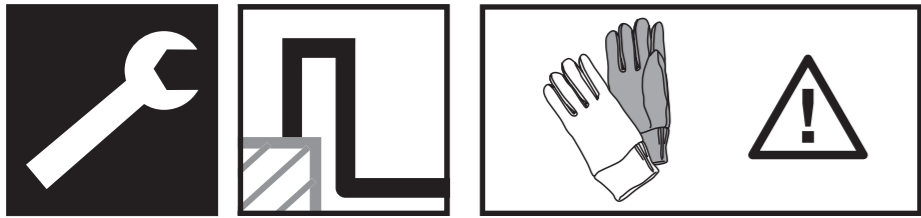

✓ OK
✗ not OK

	+2 mm / -1 mm		C
	A	B	
BLANCOATTIKA 60/A	545 mm	440 mm	-27 mm
BLANCOATTIKA XL 60	508 mm	408 mm	-46 mm

